

---

# Leveling Mounts

*Catalog Pages 42 – 47*



**651-353-6891**  
**[www.idsmachine.com](http://www.idsmachine.com)**

---

## Leveling Mounts

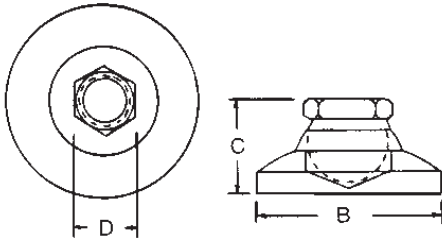

- 10 degree swivel in all directions to keep machine tools, racks, assembly lines, and other equipment level.
- Available in steel or stainless steel
- Do not exceed load requirements
- Hardened ball insures proper seating

		INCH					
Steel PART #	Stainless Steel PART #	Thread X	B	C	D	Load Pounds	
LM-100	LM-100SS	10-32	3/4	17/32	3/8	700	
LM-101	LM-101SS	1/4-20	1	45/64	1/2	1000	
LM-102	LM-102SS	3/8-16	1-1/4	7/8	5/8	3750	
LM-103	LM-103SS	1/2-13	1-7/8	1-1/8	3/4	5000	
LM-104	LM-104SS	5/8-11	2-1/2	1-1/4	7/8	6000	
LM-105	-	3/4-10	3	1-1/2	1-1/16	7400	
LM-106	-	1-8	4	1-7/8	1-3/8	20000	
LM-107	LM-107SS	1-1/4-7	6	2-3/4	1-7/8	43000	

		METRIC					
Steel PART #	Stainless Steel PART #	Thread X	B	C	D	Load Kilos	
LM-200	LM-200SS	M6	19mm	14mm	10mm	310	
LM-201	LM-201SS	M8	26	18	13	450	
LM-202	LM-202SS	M10	32	22	16	1700	
LM-203	LM-203SS	M12	48	29	19	2250	
LM-204	LM-204SS	M16	64	32	22	2720	
LM-205	LM-205SS	M20	76	38	27	3350	
LM-206	LM-206SS	M24	101	48	35	9070	
LM-207	LM-207SS	M30	152	70	48	18700	

## Leveling Mounts with Bolts

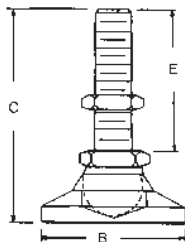

- 10 degree swivel in all directions to keep machine tools, racks, assembly lines, and other equipment level.
- Steel ball hardened for proper seating
- Jam nut included
- Available in inch and metric sizes
- Available in steel or stainless steel

		INCH						
Steel PART #	Stainless Steel PART #	Thread X	B	C	D	E	Load Pounds	
LM-300	LM-300SS	10-32	3/4	1-17/32	3/8	1	700	
LM-301	LM-301SS	1/4-20	1	1-61/64	1/2	1-1/4	1000	
LM-302	LM-302SS	3/8-16	1-1/4	2-7/8	5/8	2	3750	
LM-303	LM-303SS	1/2-13	1-7/8	3-1/8	3/4	2	5000	
LM-304	LM-304SS	5/8-11	2-1/2	3-1/4	7/8	2	6000	
LM-305	LM-305SS	3/4-10	3	3-1/2	1-1/16	2	7400	
LM-306	LM-306SS	1-8	4	5-3/8	1-3/8	3-1/2	20000	
LM-307	LM-307SS	1-8	4	6-1/8	1-3/8	4-1/4	20000	
LM-308	LM-308SS	1-1/4-7	6	6-3/4	1-7/8	4	43000	
LM-309	LM-309SS	1-1/4-7	6	8-3/4	1-7/8	6	43000	

		METRIC					
Steel PART #	Stainless Steel PART #	Thread X	B	C	D	Load Kilos	
LM-400	LM-400SS	M6	19mm	39mm	25mm	317	
LM-401	LM-401SS	M8	26	50	31	453	
LM-402	LM-402SS	M10	32	73	51	1701	
LM-403	LM-403SS	M12	48	79	51	2268	
LM-404	LM-404SS	M16	64	83	51	2721	
LM-405	LM-405SS	M20	76	89	51	3357	
LM-406	LM-406SS	M24	101	136	88	9072	
LM-407	LM-407SS	M24	101	149	108	9072	
LM-408	LM-408SS	M30	152	171	102	18730	
LM-409	LM-409SS	M30	152	222	152	18730	

**Anti-Vibration Leveling Mounts**

- ▶ Designed for high precision and computerized machinery
- ▶ Do not exceed load capacity
- ▶ 10 degree swivel in all directions to keep machinery level on uneven surfaces
- ▶ Additional load standards available upon request



INCH					
PART #	X Thread	B	C	D	Load Pounds
LM-150	3/8-16	1-1/4	1-1/2	5/8	100
LM-151	1/2-13	1-7/8	1-3/4	3/4	240
LM-152	5/8-11	2-1/2	1-7/8	7/8	440
LM-153	3/4-10	3	2-1/8	1-1/16	650
LM-154	1-8	4	2-1/2	1-3/8	1180
LM-155	1-1/4-7	6	2-7/8	1-7/8	2710

METRIC					
PART #	X Thread	B	C	D	Load Kilos
LM-250	M10	32mm	38mm	16mm	45
LM-251	M12	48	44	19	109
LM-252	M16	64	48	22	200
LM-253	M20	76	54	27	295
LM-254	M24	102	64	35	535

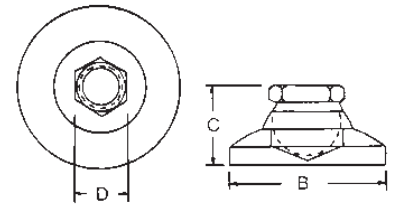

**Anti-Vibration Leveling Mounts with bolts**

INCH					
PART #	X Thread	B	C	E	Load Pounds
LM-350	3/8-16	1-1/4	3-1/2	2	100
LM-351	1/2-13	1-7/8	3-3/4	2	240
LM-352	5/8-11	2-1/2	3-7/8	2	440
LM-353	3/4-10	3	4-1/8	2	650
LM-354	1-8	4	6	3-1/2	1180
LM-355	1-8	4	6-1/8	4-1/4	535
LM-356	1-1/4-7	6	6-7/8	4	2710
LM-357	1-1/4-7	6	8-3/4	6	1230

METRIC					
PART #	X Thread	B	C	E	Load Kilos
LM-450	M10	32mm	89mm	51mm	45
LM-451	M12	48	95	51	109
LM-452	M16	64	99	51	200
LM-453	M20	76	105	51	295
LM-454	M24	102	154	90	535
LM-455	M24	102	154	108	535
LM-456	M30	152	171	102	1230
LM-457	M30	152	222	152	1230

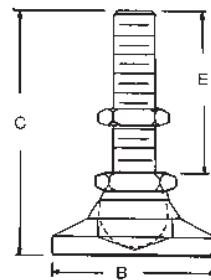

- ▶ Designed for high precision and computerized machinery
- ▶ Do not exceed load capacity
- ▶ 10 degree swivel in all directions to keep machinery level on uneven surfaces
- ▶ Additional load standards available upon request
- ▶ Jam nut included

## Delrin Leveling Mounts

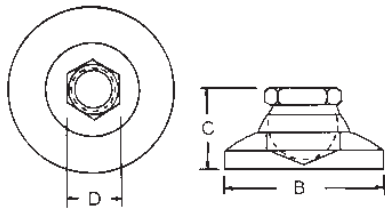

- 10 degree swivel in any direction to keep machine tools, racks, assembly lines, and other equipment level.
- Hardened ball insures proper seating
- Available in inch and metric sizes

INCH					
PART #	X Thread	B	C	D	Load Pounds
DLM-100	10-32	3/4	17/32	3/8	150
DLM-101	1/4-20	1	45/64	1/2	200
DLM-102	3/8-16	1-1/4	7/8	5/8	300
DLM-103	1/2-13	1-7/8	1-1/8	3/4	700
DLM-104	5/8-11	2-1/2	1-1/4	7/8	1200
DLM-105	3/4-10	3	1-1/2	1-1/16	1800
DLM-106	1-8	4	1-7/8	1-3/8	2000
DLM-107	1-1/4-7	6	2-7/8	1-7/8	3200

METRIC					
PART #	X Thread	B	C	D	Load Kilos
DLM-200	M6	19mm	14mm	10mm	68
DLM-201	M8	26	18	13	91
DLM-202	M10	32	22	16	136
DLM-203	M12	48	29	19	317
DLM-204	M16	64	32	22	544
DLM-205	M20	76	38	27	816
DLM-206	M24	101	48	35	907
DLM-207	M30	152	70	48	1800

## Delrin Leveling Mounts with bolts

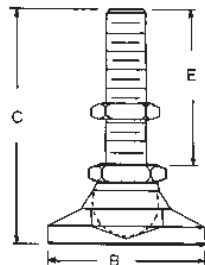

- 10 degree swivel in any direction to keep machine tools, racks, assembly lines, and other equipment level.
- Hardened ball insures proper seating
- Available in inch and metric sizes
- Jam nut included

INCH					
PART #	X Thread	B	C	E	Load Pounds
DLM-300	10-32	3/4	1-17/32	1	150
DLM-301	1/4-20	1	1-15/16	1-1/4	200
DLM-302	3/8-16	1-1/4	2-7/8	2	300
DLM-303	1/2-13	1-7/8	3-1/8	2	700
DLM-304	5/8-11	2-1/2	3-1/4	2	1200
DLM-305	3/4-10	3	3-1/2	2	1800
DLM-306	1-8	4	5-3/8	3-1/2	2000
DLM-307	1-8	4	6-1/8	4-1/4	2000
DLM-308	1-1/4-7	6	6-3/4	4	3200
DLM-309	1-1/4-7	6	8-3/4	6	3200

METRIC					
PART #	X Thread	B	C	E	Load Kilos
DLM-400	M6	19mm	39mm	25mm	68
DLM-401	M8	26	50	31	91
DLM-402	M10	32	73	51	136
DLM-403	M12	48	79	51	317
DLM-404	M16	64	83	51	544
DLM-405	M20	76	89	51	816
DLM-406	M24	101	136	88	907
DLM-407	M24	101	150	108	907
DLM-408	M30	152	171	102	1800
DLM-409	M30	152	222	152	1800

## Nylon Leveling Mounts

- ▶ Nylon base is water and corrosion resistant
- ▶ 15 degree swivel in any direction to keep machine tools, racks assembly lines, and other equipment level.
- ▶ Lag holes
- ▶ Inch and metric sizes available
- ▶ Steel and stainless steel components available

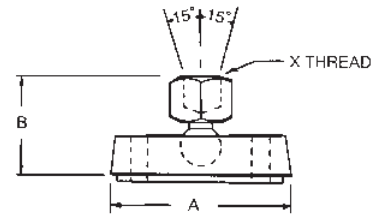
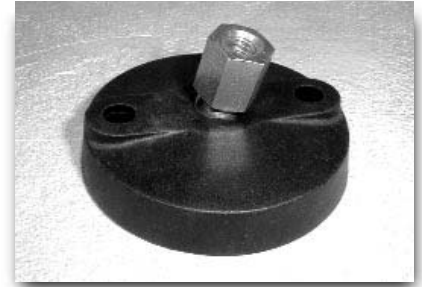

		INCH			
Steel PART #	Stainless Steel PART #	Thread X	A	B	Load Pounds
LM-120	LM-120SS	3/8-16	2	1-5/8	4000
LM-121	LM-121SS	1/2-13	2	1-5/8	4000
LM-122	LM-122SS	5/8-11	2	1-5/8	4000
LM-123	LM-123SS	3/8-16	3	1-5/8	5000
LM-124	LM-124SS	1/2-13	3	1-5/8	5000
LM-125	LM-125SS	5/8-11	3	1-5/8	5000
LM-126	LM-126SS	3/4-10	3	1-5/8	5000

		METRIC			
Steel PART #	Stainless Steel PART #	Thread X	A	B	Load Kilos
LM-220	LM-220SS	M10	50mm	41mm	1815
LM-221	LM-221SS	M12	50	41	1815
LM-222	LM-222SS	M16	50	41	1815
LM-223	LM-223SS	M10	80	41	2268
LM-224	LM-224SS	M12	80	41	2268
LM-225	LM-225SS	M16	80	41	2268
LM-226	LM-226SS	M20	80	41	2268

## Nylon Leveling Mounts with bolts

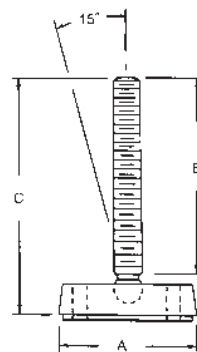

Steel PART #	Stainless Steel PART #	Thread X	A	B	C	Load Pounds
LM-320	LM-320SS	3/8-16	2	4	4-7/8	4000
LM-321	LM-321SS	3/8-16	2	6	6-7/8	4000
LM-322	LM-322SS	3/8-16	2	8	8-7/8	4000
LM-323	LM-323SS	1/2-13	2	4	4-7/8	4000
LM-324	LM-324SS	1/2-13	2	6	6-7/8	4000
LM-325	LM-325SS	1/2-13	2	8	8-7/8	4000
LM-326	LM-326SS	5/8-11	2	4	4-7/8	4000
LM-327	LM-327SS	5/8-11	2	6	6-7/8	4000
LM-328	LM-328SS	5/8-11	2	8	8-7/8	4000
LM-329	LM-329SS	3/8-16	3	4	4-7/8	5000
LM-330	LM-330SS	3/8-16	3	6	6-7/8	5000
LM-331	LM-331SS	3/8-16	3	8	8-7/8	5000
LM-332	LM-332SS	1/2-13	3	4	4-7/8	5000
LM-333	LM-333SS	1/2-13	3	6	6-7/8	5000
LM-334	LM-334SS	1/2-13	3	8	8-7/8	5000
LM-335	LM-335SS	5/8-11	3	4	4-7/8	5000
LM-336	LM-336SS	5/8-11	3	6	6-7/8	5000
LM-337	LM-337SS	5/8-11	3	8	8-7/8	5000
LM-338	LM-338SS	3/4-10	3	4	4-7/8	5000
LM-339	LM-339SS	3/4-10	3	6	6-7/8	5000
LM-340	LM-340SS	3/4-10	3	8	8-7/8	5000

- ▶ Nylon base is water and corrosion resistant
- ▶ 15 degree swivel in any direction to keep machine tools, racks, assembly lines, and other equipment level.
- ▶ Lag holes
- ▶ Inch and metric sizes available
- ▶ Steel and stainless steel components available
- ▶ Jam nut included

## Nylon Leveling Mounts

metric with bolts

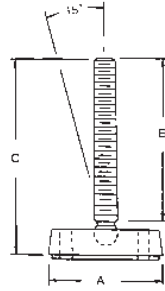

- Nylon base is water and corrosion resistant
- 15 degree swivel in any direction to keep machine tools, racks, assembly lines, and other equipment level
- Lag holes
- Inch and metric sizes available
- Steel and stainless steel components available
- Jam nut included

Steel PART #	Stainless Steel PART #	METRIC				Load Kilos
		X Thread	A	B	C	
LM-420	LM-420SS	M10	50mm	102mm	123mm	1815
LM-421	LM-421SS	M10	50	152	175	1815
LM-422	LM-422SS	M10	50	203	225	1815
LM-423	LM-423SS	M12	50	102	123	1815
LM-424	LM-424SS	M12	50	152	175	1815
LM-425	LM-425SS	M12	50	203	225	1815
LM-426	LM-426SS	M16	50	102	123	1815
LM-427	LM-427SS	M16	50	152	175	1815
LM-428	LM-428SS	M16	50	203	225	1815
LM-429	LM-429SS	M10	80	102	123	2268
LM-430	LM-430SS	M10	80	152	175	2268
LM-431	LM-431SS	M10	80	203	225	2268
LM-432	LM-432SS	M12	80	102	123	2268
LM-433	LM-433SS	M12	80	152	175	2268
LM-434	LM-434SS	M12	80	203	225	2268
LM-435	LM-435SS	M16	80	102	123	2268
LM-436	LM-436SS	M16	80	152	175	2268
LM-437	LM-437SS	M16	80	203	225	2268
LM-438	LM-438SS	M20	80	102	123	2268
LM-439	LM-439SS	M20	80	152	175	2268
LM-440	LM-440SS	M20	80	203	225	2268

## Industrial Glides



- Steel with nickel plated finish
- Nylon base pad provides non-abrasive surface
- Excellent for leveling light duty machines, cabinets, and office furniture
- Economical leveling solution

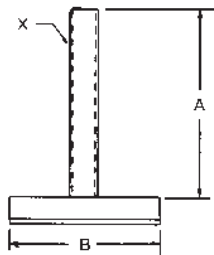

PART #	INCH			PART #	METRIC		
	X Thread	A	B		X Thread	A	B
GR-01	10-24	1-1/2	1-1/4	MGR-01	M6	38mm	31mm
GR-02	1/4-20	1-1/2	1-1/4	MGR-02	M8	38	31
GR-03	5/16-18	1-1/2	1-1/4	MGR-03	M8	38	52
GR-04	5/16-18	2	2	MGR-04	M10	51	52
GR-05	3/8-16	2	2	MGR-05	M10	51	61
GR-06	3/8-16	2	2-13/32	MGR-06	M10	102	61
GR-07	3/8-16	4	2-13/32	MGR-07	M12	51	61
GR-08	1/2-13	2	2-13/32	MGR-08	M12	102	61
GR-09	1/2-13	4	2-13/32	MGR-09	M12	51	71
GR-10	1/2-13	2	2-3/4	MGR-10	M12	102	71
GR-11	1/2-13	4	2-3/4	MGR-11	M16	51	71
GR-12	5/8-11	2	2-3/4	MGR-12	M16	102	71
GR-13	5/8-11	4	2-3/4	MGR-13	M12	102	81
GR-14	1/2-13	4	3-3/16	MGR-14	M12	152	81
GR-15	1/2-13	6	3-3/16	MGR-15	M16	102	81
GR-16	5/8-11	4	3-3/16	MGR-16	M16	152	81
GR-17	5/8-11	6	3-3/16				

**Fixed-Base Leveling Mounts**

- ▶ Inch and metric sizes available
- ▶ Non-slip black plastic base
- ▶ Steel screw, zinc plated finish
- ▶ Mounts let you isolate height on all types of machinery and equipment

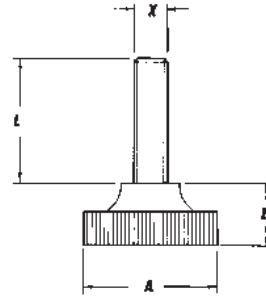

PART #	INCH			
	X	L	A	B
7832AC020	1/4-20	3/4	1-1/4	9/16
7832AC030	1/4-20	1-3/16	1-1/4	9/16
7832AC040	1/4-20	1-1/2	1-1/4	9/16
7832AD020	5/16-18	3/4	1-1/4	9/16
7832AD030	5/16-18	1-3/16	1-1/4	9/16
7832AD040	5/16-18	1-1/2	1-1/4	9/16
7832AE030	3/8-16	1-3/16	1-1/4	9/16
7832AE040	3/8-16	1-1/2	1-1/4	9/16

PART #	METRIC			
	X	L	A	B
783206020	M6	20mm	32mm	14.5mm
783206030	M6	30	32	14.5
783206040	M6	40	32	14.5
783208020	M8	20	32	14.5
783208030	M8	30	32	14.5
783208040	M8	40	32	14.5
783210030	M10	30	32	14.5
783210040	M10	40	32	14.5

**Fixed-Base Leveling Mounts**  
metric

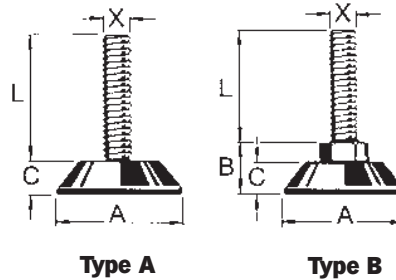

- ▶ Base material: thermoplastic (black)
- ▶ Steel screw, zinc-plated
- ▶ Type A: without hex
- ▶ Type B: with hex

Type A PART #	Type B PART #	Hex	X	L	A	B	C
LV-50	LV-50B	SW13	M6	20mm	30mm	15mm	10mm
LV-51	LV-51B	SW13	M6	40	30	15	10
LV-52	LV-52B	SW13	M8	20	30	15	10
LV-53	LV-53B	SW13	M8	40	30	15	10
LV-54	LV-54B	SW13	M8	30	47	15	10
LV-55	LV-55B	SW13	M8	50	47	15	10
LV-56	LV-56B	SW17	M10	30	47	15	10
LV-57	LV-57B	SW17	M10	50	47	15	10



6602 Upper 28<sup>th</sup> St. N.  
Oakdale, MN 55128

email: [sales@idsmachine.com](mailto:sales@idsmachine.com)

**651-353-6891**  
[www.idsmachine.com](http://www.idsmachine.com)

---